

475 Greenwich Street Between Canal and Watts Prime Tribeca Retail space for Lease



Neighboring Tenants: George Smith Furniture, Dylan Prime Steakhouse and Wolfgang's Steakhouse.

Ground Floor: 2447 sq ft (approx)

Rental Price: Upon request

Frontage: 67 feet on Greenwich Street
67 feet on Canal Street

Possession: Immediate

Term: Negotiable

Notes: New HVAC
2 ADA complaint bathrooms
300 Amps

Jamie Weiner x12

David Kevelson x 27

The Manhattes Group LLC 54 Thompson st 2nd Floor NY, NY 10012

212-334-4666



The Manhattes Group LLC

475
Greenwich Street

Floor Plan

GROUND FLOOR

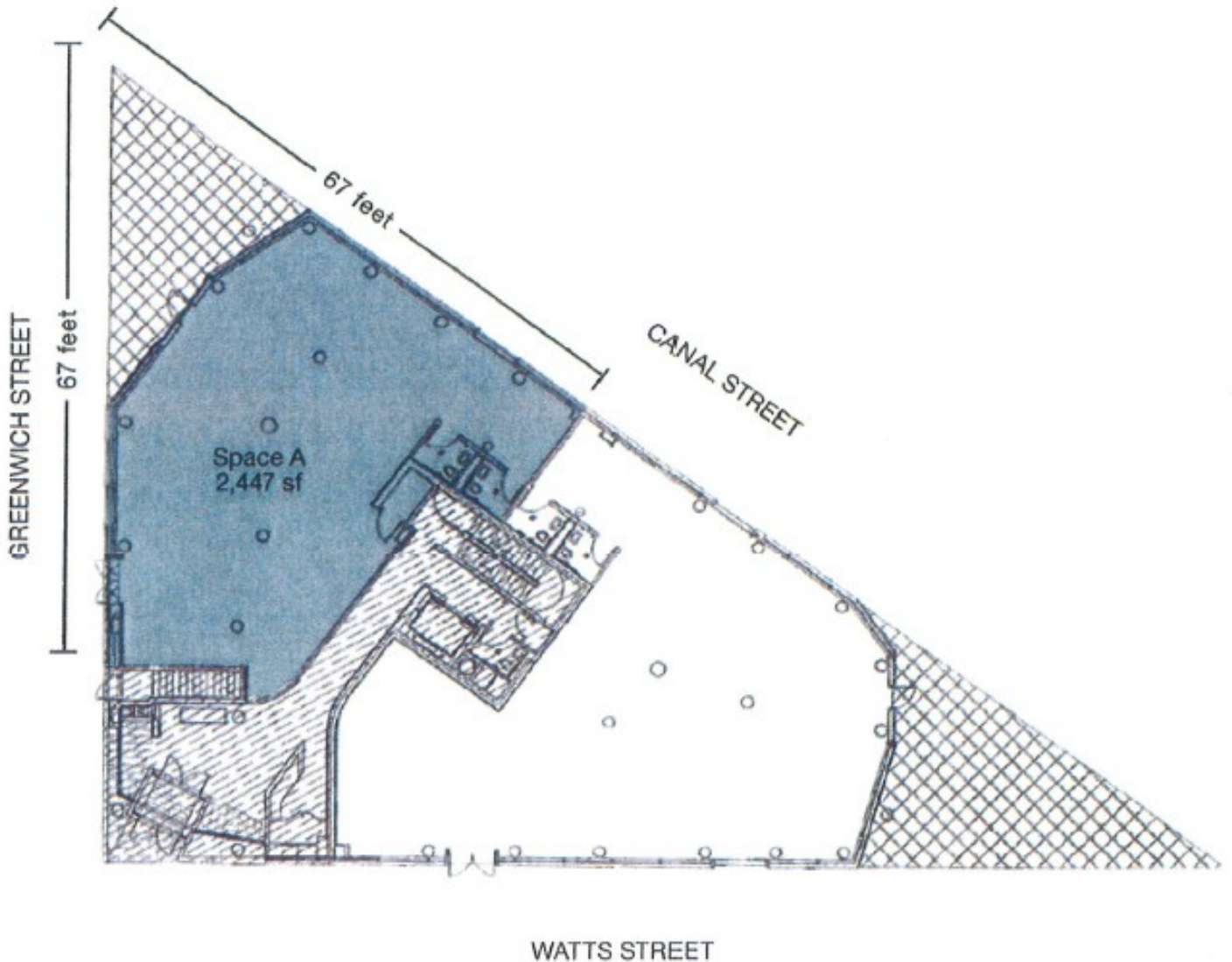

Jamie Weiner x12

David Kevelson x 27

The Manhattes Group LLC 54 Thompson st 2nd Floor NY, NY 10012

212-334-4666

MAP

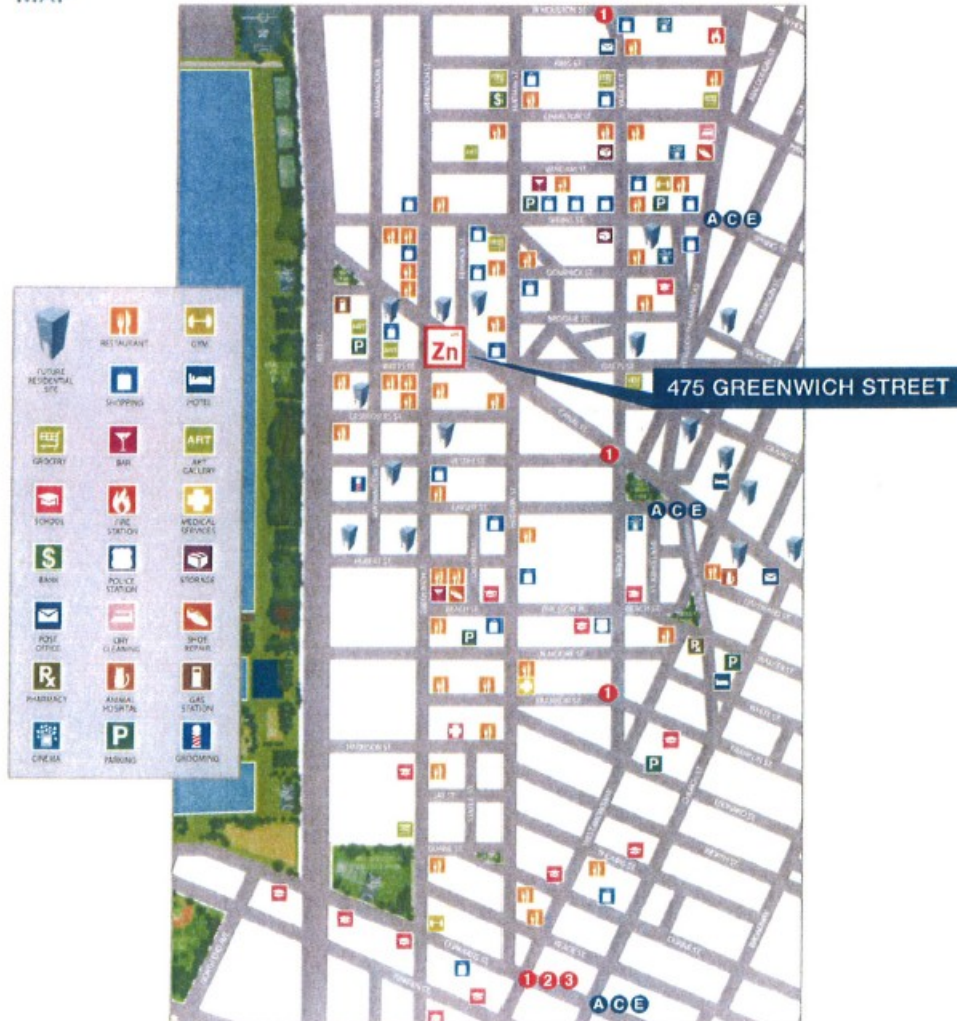

Comments:

- An additional 2,906 sf of Ground Floor space can be made available
- At the base of the Zinc Building, a new 7-story, 21-unit residential condominium
- Floor-to-ceiling glass facade
- Within blocks of the new Trump SoHo Hotel Condominium New York
- One block from the Holland Tunnel
- Heavily trafficked location
- Phenomenal signage potential

Jamie Weiner x12

David Kevelson x 27

The Manhattes Group LLC 54 Thompson st 2nd Floor NY, NY 10012
212-334-4666